

PWB60A40 SANREX

Specification

- IT(AV) 60A (each device)
- High Surge Current 1800 A (60Hz)
- Easy Construction
- Non-isolated. Mounting base as common Anode terminal

Maximum Ratings

Symbol	Item	Rating
		PWB60A40
VRRM	Repetitive Peak Reverse Voltage	400V
VRSM	Non-Repetitive Peak Reverse Voltage	480V
VDRM	Repetitive Peak Off-State Voltage	400V

1,800.-

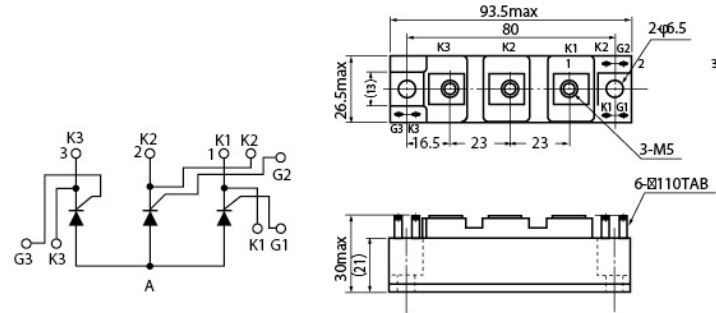

Unit : A

PWB80A40

Specification

- IT(AV) 80A (each device)
- High Surge Current 2500 A (60Hz)
- Easy Construction
- Non-isolated. Mounting base as common Anode terminal

Maximum Ratings

Symbol	Item	Rating
		PWB80A40
VRRM	Repetitive Peak Reverse Voltage	400V
VRSM	Non-Repetitive Peak Reverse Voltage	480V
VDRM	Repetitive Peak Off-State Voltage	400V

2,300.-

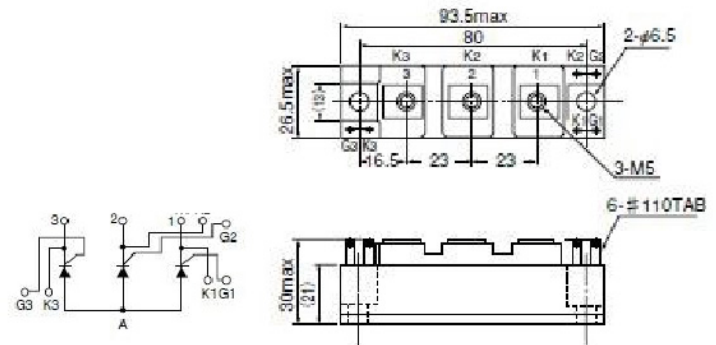

Unit: mm

PWB100A40 SANREX

Specification

- IT(AV)100A (each device)
- High Surge Current 3500 A (60Hz)
- Easy Construction
- Non-isolated. Mounting base as common Anode terminal

Maximum Ratings

Symbol	Item	Rating
		PWB100A40
VRRM	Repetitive Peak Reverse Voltage	400V
VRSM	Non-Repetitive Peak Reverse Voltage	480V
VDRM	Repetitive Peak Off-State Voltage	400V

3,000.-

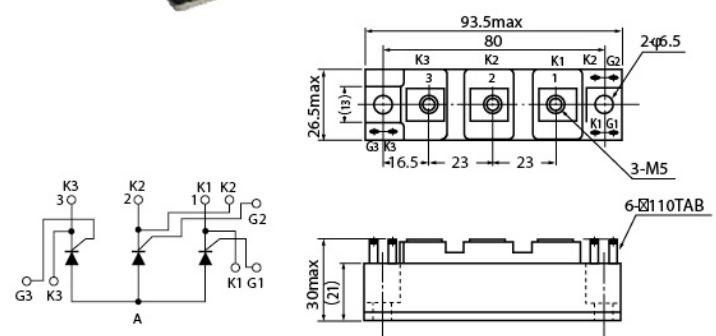

Unit: mm

PWB130A40 SANREX

Specification

- IT(AV)130A (each device)
- High Surge Current 3500 A (50/60Hz)
- Easy Construction
- Non-isolated. Mounting base as common Anode terminal

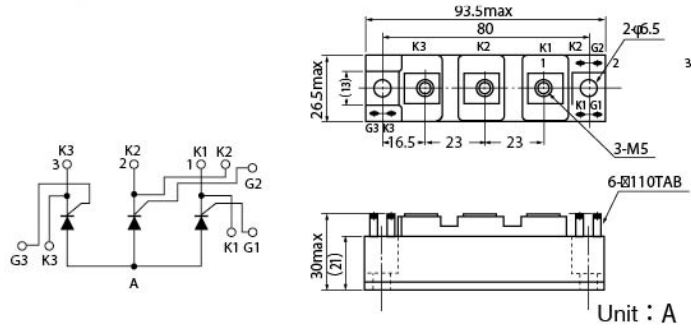

Maximum Ratings

Symbol	Item	Rating
		PWB130A40
VRRM	Repetitive Peak Reverse Voltage	400V
VRSM	Non-Repetitive Peak Reverse Voltage	480V
VDRM	Repetitive Peak Off-State Voltage	400V

3,200.-

DF20CA120 SANREX

Specification

- TjMax = 150 degree
- Isolated Mounting Base
- High reliability by unique glass passivation
- Easy Assemble by the #250 terminal Tab

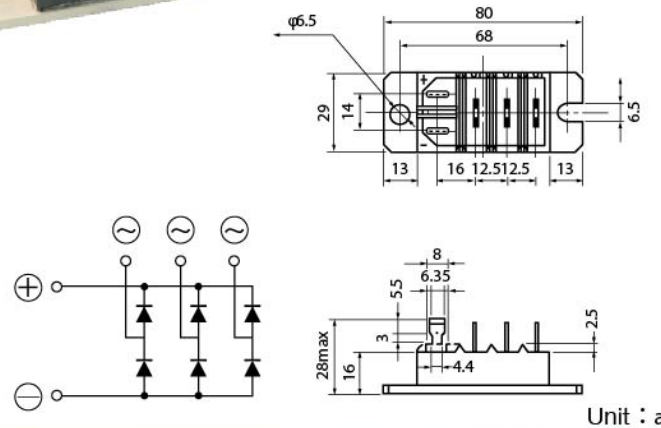

Maximum Ratings

Symbol	Item	Rating
		DF20AA120
VRRM	Repetitive Peak Reverse Voltage	1200V
VRSM	Non-Repetitive Peak Reverse Voltage	1300V

800.-

Diode Module MMF200ZB040DK1 MACMIC

ใช้สำหรับใส่กับเครื่อง MIG 250Y

Specification

VRRM (V)	400
IF(AV) Duty = 0.5 Tc = 110°C (A)	100x2
IFSM t=10ms TJ=45°C (A)	1500
VFM @IFM (V) (A)	1.1 100
tm@* (ns)	150
ReJC (°C/W)	0.20
Inside Circuit	DK1
Package Style	FZ

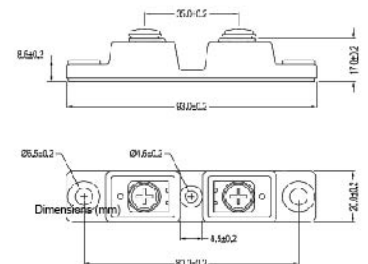

1,200.-

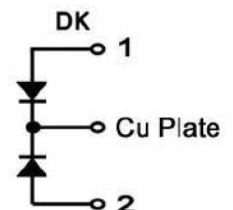

สวิตช์เปิด-ปิด รุ่น JD03-A1-A05-108 Rocker Switch Mod. JD03-A1-A05-108

Function: ON-OFF

Rating: 25A 125/250VAC

สวิตช์ 4 ขา ไม่มีไฟแสดงสถานะ: รองรับการแอสไฟ
ได้ถึง 25A ใช้เป็นสวิตช์สำหรับงานรับกระแสสูง เช่น
ตู้เชื่อม เหมาะกับตู้เชื่อมที่มี power โขว์ที่ตัวเครื่อง

Net Weigth : 14g/pc
: 751g/box

60.-/PC
1,000Pcs/Carton

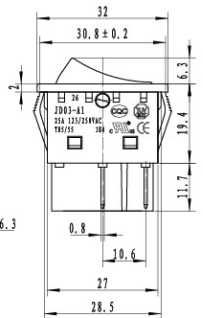
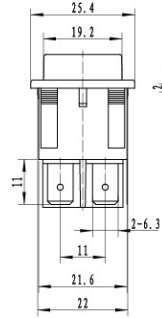
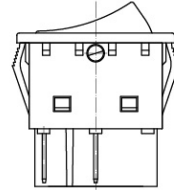
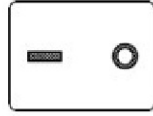
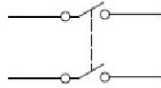

สวิตช์เปิด-ปิด รุ่น JD03-A1-A05-141 Rocker Switch Mod. JD03-A1-A05-141

Function: ON-OFF

Rating: 25A 125/250VAC

สวิตช์ 4 ขา ไม่มีไฟแสดงสถานะ: รองรับการแอสไฟ
ได้ถึง 25A ใช้เป็นสวิตช์สำหรับงานรับกระแสสูง เช่น
ตู้เชื่อม เหมาะกับตู้เชื่อมที่ไม่มี power หรือต้องการ
แสดงสถานะการทำงานของสวิตช์

Net Weigth : 16g/pc
: 853g/box

60.-/PC
1,000Pcs/Carton

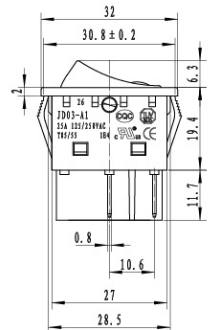
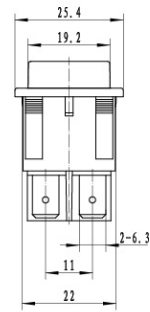
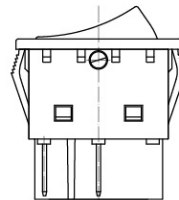
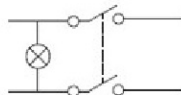

สวิตช์เปิด-ปิด รุ่น JD03-A1-A06-170 Rocker Switch Mod. JD03-A1-A06-170

Function: ON-OFF

Rating: 30A 125/250VAC

สวิตช์ 6 ขา มีไฟ LED แสดงสถานะ: รองรับการแอสไฟ
ได้ถึง 30A ใช้เป็นสวิตช์สำหรับงานรับกระแสสูง
เช่น ตู้เชื่อม และสามารถใช้สำหรับแปลงเพื่อใช้กับ
พัดลม 220V

Net Weigth : 18g/pc
: 953g/box

80.-/PC
1,000Pcs/Carton

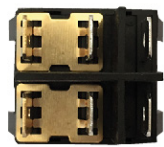
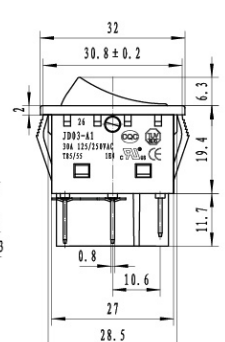
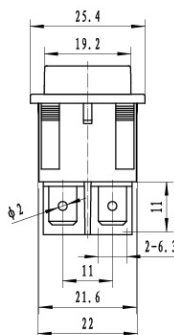
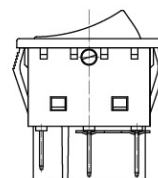
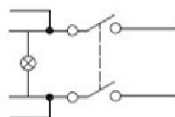

Miniature Toggle Switch

Specification

1. Rating: 6A 125VAC;3A 250VAC
2. Contact Resistance: 20m Ω max
3. Insulation Resistance: 1000M Ω min.
4. Dielectric Strength:1500VAC, 1 Minute
5. Operating Temperature: -25°C~+85°C
6. Electrical Life: 10,000 Cycles

MTS -101

สำหรับปรับระบบหน่วงเวลาเครื่อง TIG

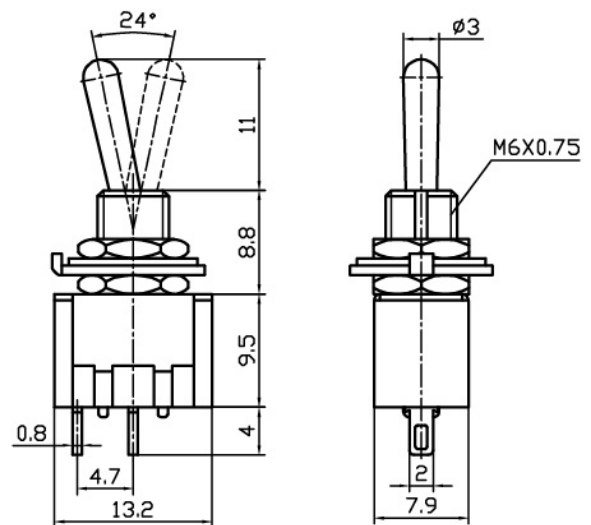
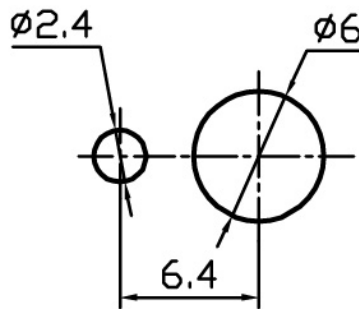

MTS -202

สำหรับเครื่องเชื่อม TIG 1STICK ในการปรับระบบเชื่อม

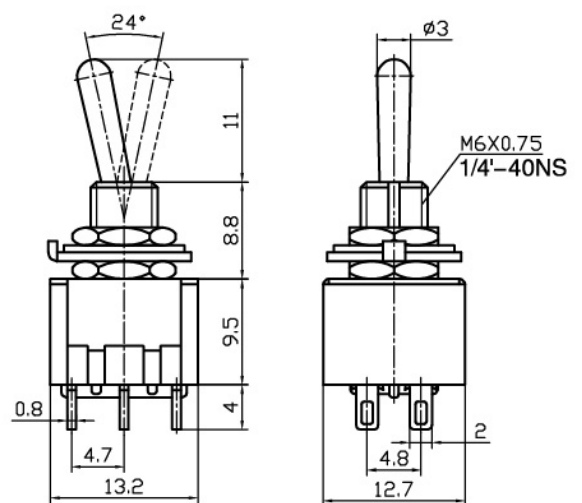
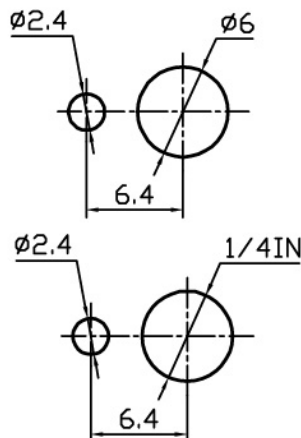

Model	Product Description	Function	Rating	Terminals	Type	Packing	Price
MTS-101	Miniature Toggle Switch Mod. MTS-101 สวิตช์โยกเล็ก รุ่น MTS-101	ON-OFF	3A 250VAC	2P	SPST	2500Pcs/Carton 100Pcs/Box	15.-
MTS-202	Miniature Toggle Switch Mod. MTS-202 สวิตช์โยกเล็ก รุ่น MTS-202	ON-ON	3A 250VAC	6P	DPDT	2500Pcs/Carton 100Pcs/Box	20.-

Medium Toggle Switch

Specification

1. Rating: () 10A 125VAC:6A 250VAC
(A) 15A 125VAC:10A 250VAC
(AA) 20A 125VAC:15A 250VAC
2. Contact Resistance: 50m Ω max
3. Insulation Resistance: 500VDC 1000M Ω min
4. Dielectric Strength: 1500VAC, 1Minute
5. Operating Temperature: -25°C~+85°C
6. Electrical Life: 10,000 Cycles

KN3C-201AP

สำหรับเป็นสวิตช์เปิด-ปิด KR11- 390, 500

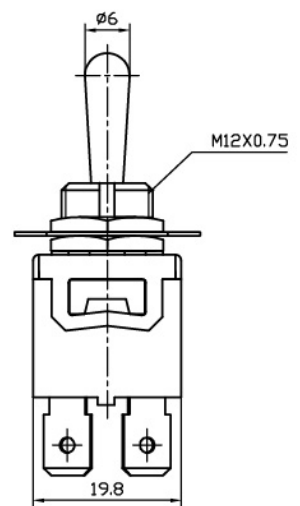
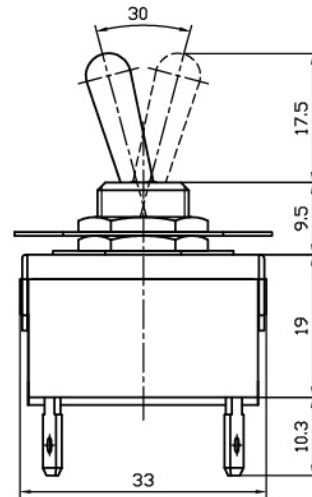
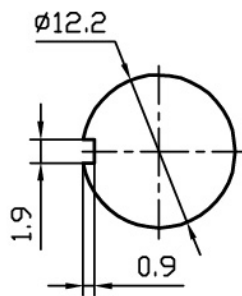

KN3C-202AP

สำหรับเครื่องเชื่อม MiniTig-200 SUMO และ MiniTig-150 Panasonic ในารปรับระบบเชื่อม

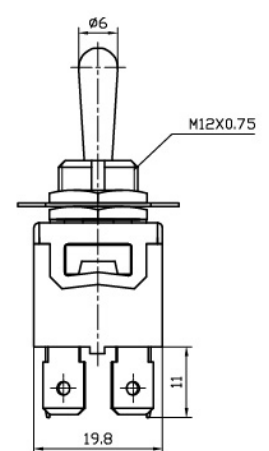
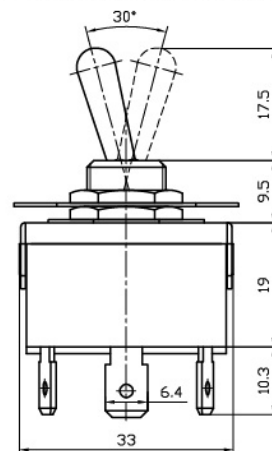
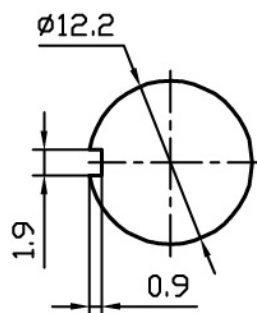
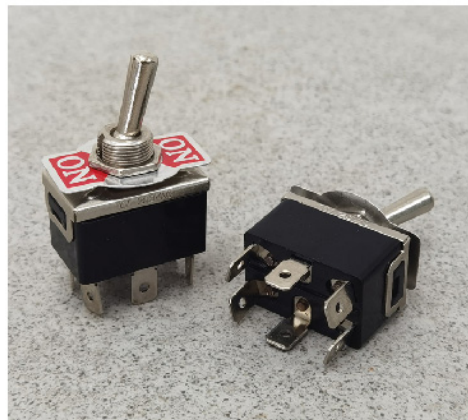

Model	Product Description	Function	Rating	Terminals	Type	Packing	Price
KN3C-201AP	Medium Toggle Switch Mod. KN3C-201AP สวิตช์แยก รุ่น KN3C-201AP	ON-OFF	6A 250VAC	4P	DPST	500Pcs/Carton 25Pcs/Box	50.-
KN3C-202AP	Medium Toggle Switch Mod. KN3C-202AP สวิตช์แยก รุ่น KN3C-202AP	ON-ON	6A 250VAC	6P	DPDT	500Pcs/Carton 25Pcs/Box	50.-

***หมายเหตุ ▶ มีสินค้า

Micro Switch

Specification

1. Rating: () 10A 125/250VAC
(B) 5A 125/250VAC
2. Contact Resistance: 30m Ω max
3. Insulation Resistance: 500VDC 100M Ω min
4. Dielectric Strength: 1500VAC, 1Minute
5. Operating Temperature: -25°C~+85°C
6. Electrical Life: 100,000 Cycles

MSW-01

สำหรับใช้กับปืน CO2 Panasonic

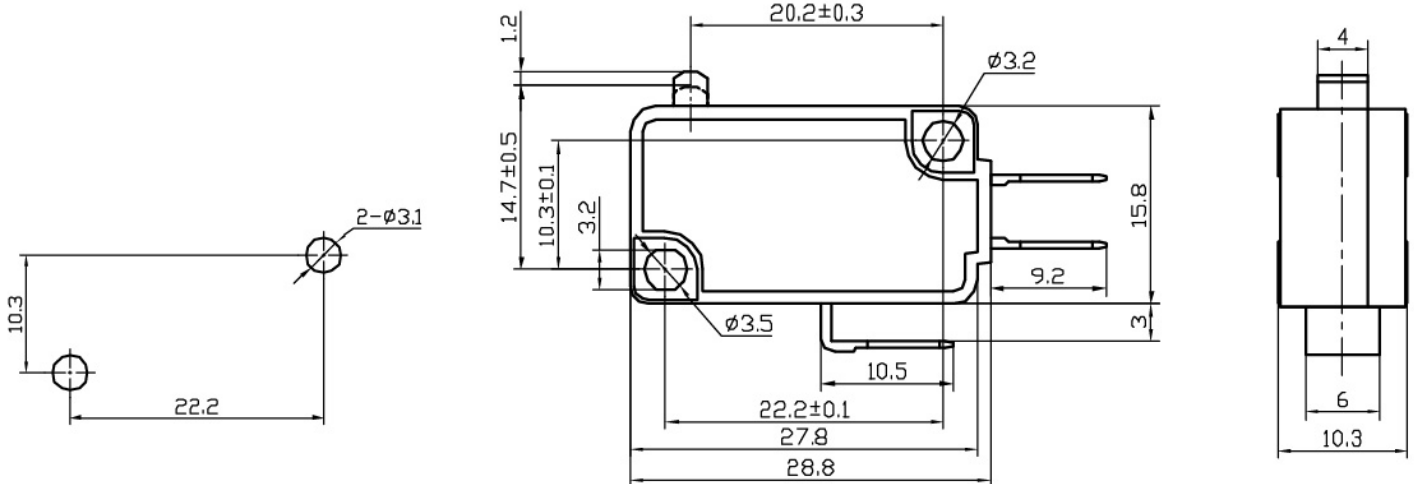
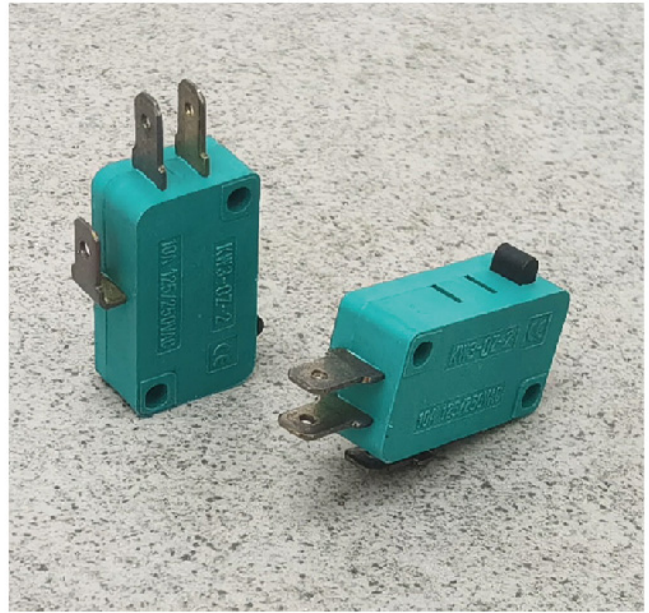

Model	Product Description	Function	Rating	Terminals	Type	Packing	Price
MSW-01	Micro Switch Mod. MSW-01 ไมโครสวิตช์ รุ่น MSW-01	ON-(ON)	10A 125/250VAC	3P	SPDT	1000Pcs/Carton 20Pcs/Box	35.-

***หมายเหตุ ▶ มีสินค้า

BUS-BAR INSULATORS SERIES

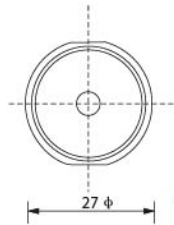
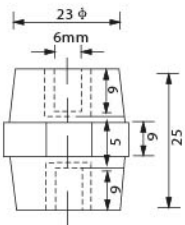

SM-25

TENSILE STRENGTH(LBS)	TORGUE STRENGTH(FT LBS)	VOLTAGE WITHSTAND(KV)	SCRE (mm)	WEIGHT (G)	Packing	Price
50	6	6	6	28		35.-

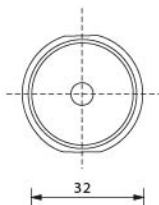
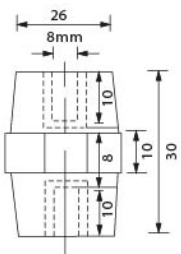

SM-30

TENSILE STRENGTH(LBS)	TORGUE STRENGTH(FT LBS)	VOLTAGE WITHSTAND(KV)	SCRE (mm)	WEIGHT (G)	Packing	Price
550	8	8	8	44		45.-

BUS-BAR INSULATORS SERIES

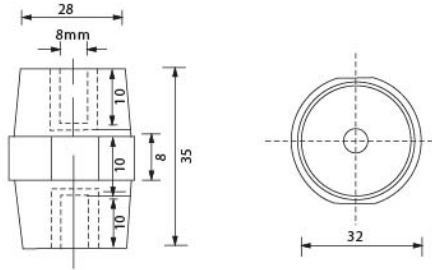

SM-35

TENSILE STRENGTH(LBS)	TORGUE STRENGTH(FT LBS)	VOLTAGE WITHSTAND(KV)	SCRE (mm)	WEIGHT (G)	Packing	Price
600	10	10	8	55		50.-

***หมายเหตุ ▶ มีสินค้า

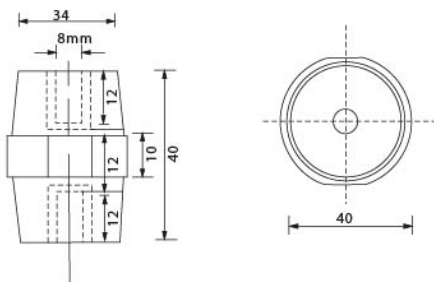

SM-40

TENSILE STRENGTH(LBS)	TORGUE STRENGTH(FT LBS)	VOLTAGE WITHSTAND(KV)	SCRE (mm)	WEIGHT (G)	Packing	Price
650	10	12	8	86		

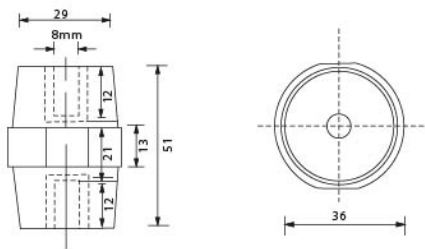

SM-51

TENSILE STRENGTH(LBS)	TORGUE STRENGTH(FT LBS)	VOLTAGE WITHSTAND(KV)	SCRE (mm)	WEIGHT (G)	Packing	Price
1000	20	15	8	83		

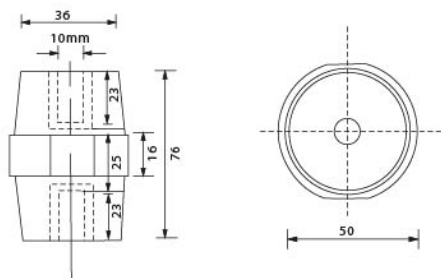

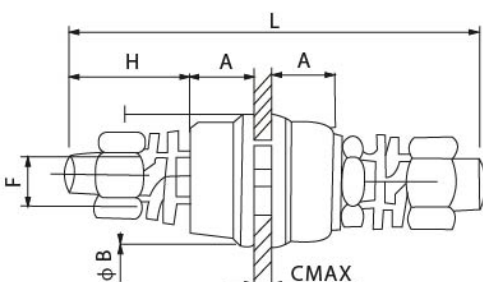

SM-76

TENSILE STRENGTH(LBS)	TORGUE STRENGTH(FT LBS)	VOLTAGE WITHSTAND(KV)	SCRE (mm)	WEIGHT (G)	Packing	Price
1500	40	25	10	233		



P1/P-6 ,P1/P-8, P1/P-10, P1/P-12

TYPE	F	L	VOLTAGE WITHSTAND(KV)	A (mm)	B (mm)	C MAX (mm)	H (mm)	Packing	Price
P1/P-6	M6	65	6	12	22	5	17		
P1/P-8	M8	80	6	13.5	25	5	21		
P1/P-10	M10	95	6	15	30	5	28		
P1/P-12	M12	105	6	17	35	5	29		

RESISTOR รีซิสเตอร์	RESISTOR รีซิสเตอร์	RESISTOR รีซิสเตอร์
<p>MZ126A</p>  <p>50.-/Pc</p>	<p>270K+270K</p>  <p>สำหรับ เครื่องเชื่อม »TIG200A »STICK 200 เครื่องตัดพลาสมา »CUT 40</p> <p>10.-</p>	<p>MO3W 510K Ω 5%</p>  <p>...-</p>
RECTIFIER BRIDGE	RECTIFIER BRIDGE	THERMAL PROTECTOR
 <p>3510 Size : 35A 1KV</p> <p>100.-</p>	 <p>5010 Size : 50A 1KV</p> <p>140.-</p>	 <p>250V 5A</p> <p>50.-</p>
RESISTOR		
 <p>NTC 47D-15</p> <p>25.-/Pc</p>		

CAPACITOR

CYS-3
9 KV, 0.002 UF



CYS-4
10 KV, 0.002 UF

CAPACITOR

RD 1000µF 50V

สำหรับเมนบอร์ด เครื่องเชื่อมทุกรุ่น ทุกแบรนด์ และเครื่องใช้ไฟฟ้าอื่นๆ

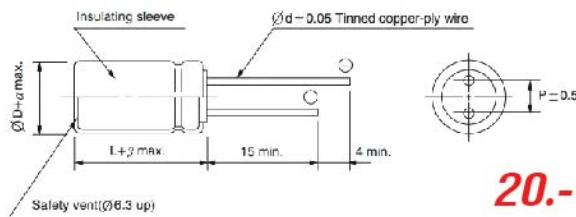

20.-

SPECIFICATION

Mounting	THT
Capacitance	1000µF
Operating voltage	50V
Body dimensions	Ø16 x 25mm
Tolerance	±20%
Service life	2000h
Operating temperature	105°C

CAPACITOR

HP 470µF 400V

สำหรับพาวเวอร์บอร์ดเครื่องเชื่อมทุกรุ่น ทุกแบรนด์

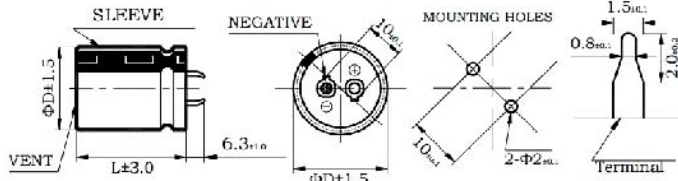

150.-

SPECIFICATION

Mounting	THT
Capacitance	470µF
Operating voltage	400V
Body dimensions	Ø35 x 50mm
Tolerance	±20%
Leads	snap-in
Service life	2000h
Operating temperature	105°C

CAPACITOR

HP 680µF 400V

สำหรับพาวเวอร์บอร์ดเครื่องเชื่อมระบบ IGBT ทุกรุ่น ทุกแบรนด์

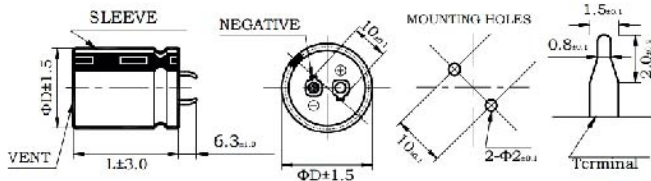

220.-

SPECIFICATION

Mounting	THT
Capacitance	680µF
Operating voltage	400V
Body dimensions	Ø35 x 50mm
Tolerance	±20%
Leads	Snap-in
Service life	2000h
Operating temperature	105°C

CAPACITOR

HA 1000µF 350V

สำหรับพาวเวอร์บอร์ด Plasma cut 100A

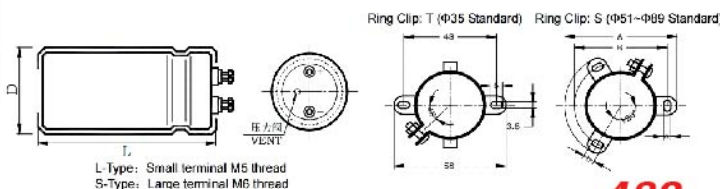

480.-

SPECIFICATION

Mounting	THT
Capacitance	1000µF
Operating voltage	350V
Body dimensions	Ø51 x 80mm
Tolerance	±20%
Leads	Screw
Service life	2000h
Operating temperature	105°C

104 1000V



ใช้ได้ทั้งเครื่อง TIG, และอุปกรณ์อิเล็กทรอนิกส์อื่นๆ

20.-/Pc

103K 630V



ใช้ได้ทั้งเครื่อง MIG, STICK, TIG, CUT และอุปกรณ์อิเล็กทรอนิกส์อื่นๆ

Capacitance range : 0.01 μ F
 Rated voltage : 630V
 Capacitance deviation : 10%

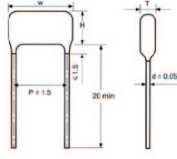

Item	W \pm 0.5	H \pm 0.5	T \pm 0.5	d	L	P
103K 630V	12	7.2	4.5	0.6	25	10

45.-/Pc

104K 630V



ใช้ได้ทั้งเครื่อง MIG, STICK, TIG, CUT และอุปกรณ์อิเล็กทรอนิกส์อื่นๆ

Capacitance range : 100 μ F
 Rated voltage : 630V
 Capacitance deviation : 10%

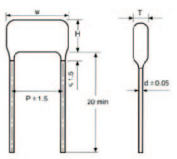

Item	W \pm 0.5	H \pm 0.5	T \pm 0.5	d	L min	P
104K 630V	17	9.6	5.9	0.7	25	15

45.-/Pc

475K 250V

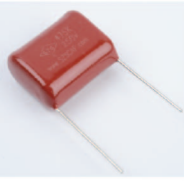

ใช้ได้ทั้งเครื่อง MIG, STICK, TIG, CUT และอุปกรณ์อิเล็กทรอนิกส์อื่นๆ

Capacitance range : 4.7 μ F
 Rated voltage : 250V
 Capacitance deviation : 10%

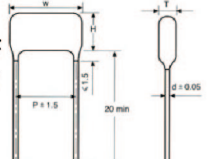

Item	W \pm 0.5	H \pm 0.5	T \pm 0.5	d	L	P
475K 250V	27	21.5	11.5	1.0 mm	25	25

30.-/Pc

475K 400V

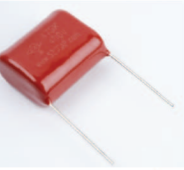

ใช้ได้ทั้งเครื่อง MIG, STICK, TIG, CUT และอุปกรณ์อิเล็กทรอนิกส์อื่นๆ

Capacitance range : 4.7 μ F
 Rated voltage : 400V
 Capacitance deviation : 10%

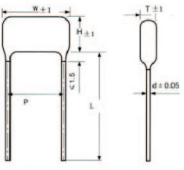

Item	W	H	T	d	L	P
475K 400V	25	24.2	13.2	1.0 mm	24	25

30.-/Pc

102 10KV

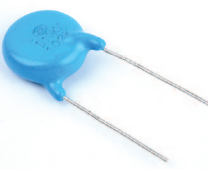

ใช้ได้ทั้งเครื่อง TIG, CUT

Dimension
 D max : 19.0mm
 T max : 8.0mm
 F : 13.0mm
 d : 0.8mm

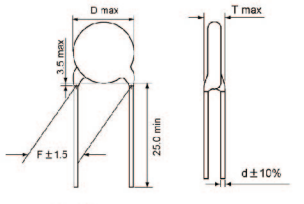

Capacitance range : 1 μ F
 Rated voltage : 10000V
 Capacitance deviation : 5%

40.-/Pc

102 4KV



ใช้ได้ทั้งเครื่อง TIG, CUT

Dimension
 Maximum diameter : 6.0 \pm 0.5mm
 Thickness : 3.5 \pm 0.5mm
 Lead length : 23 \pm 1.0mm
 Spacing : 7.5 \pm 1.0mm

Capacitance range : 1 μ F
 Rated voltage : 4V

10.-/Pc

471K 1KV

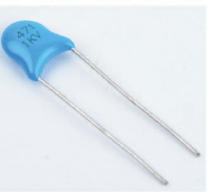

ใช้ได้ทั้งเครื่อง Stick

Dimension
 Maximum diameter : 5.5 \pm 0.5mm
 Thickness : 2.5 \pm 0.5mm
 Lead length : 20 \pm 0.5mm
 Spacing : 5.0 \pm 0.5mm

Capacitance range : 0.47 μ F
 Rated voltage : 1000V
 Capacitance deviation : 10%

5.-/Pc

Varistor 20D151K

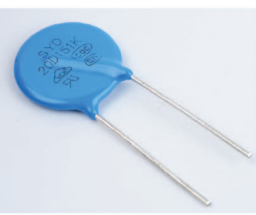

ใช้ได้กับทุกเครื่องเชื่อม

Dimension
 Maximum diameter : 21 \pm 0.15mm
 Thickness : 4.0 \pm 0.5mm
 Lead length : 25 \pm 1.0mm
 Spacing : 10.0 \pm 0.5mm

Capacitance range : 0.15 μ F
 Rated voltage : 250V
 Capacitance deviation : 10%

20.-/Pc

RELAY

PCB Relay JQX-14F 1Z 10A 24VDC



Features

- 10A high power relay
- 1A, 1B, 1C configurations
- Sealed version available
- Size: 30x13.5x21 mm.

80.-

Dimension.Bottom View

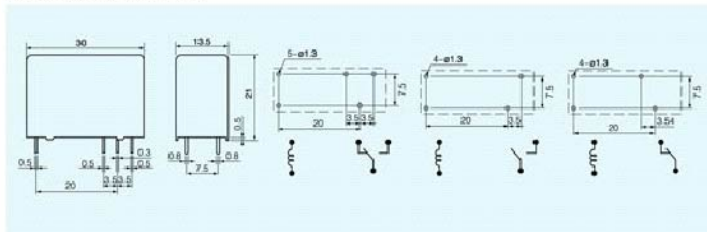

Contact Ratings

Contact Ratings	1A, 1B, 1C
Contact Resistance	50MΩ (at 1A 6VDC)
Contact Material	Silver Alloy
Contact capacity	10A 250VAC/28VDC TV-5

Coil Ratings

Rated Voltage	3~48VDC
Nominal Operating Power	0.53W,0.72W

Specification

Insulation Resistance	100MΩ
Dielectric Strength	1500VAC
Ambient Temperature	-40°C~+70°C
Operate Time	15ms/5ms
Terminal Type	PCB

RELAY

PCB Relay JQX - 15F T90 30A 24VDC

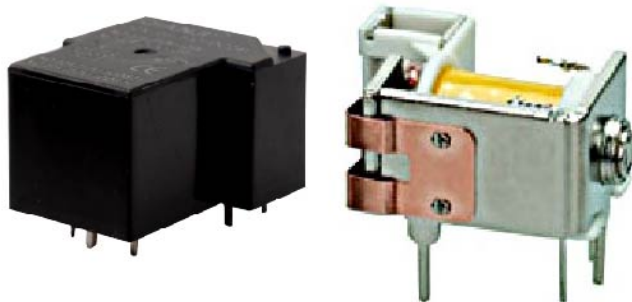

Features

- 30A Carrying current
- SPST-NO& SPDT
- PCB
- Size: 32.2x27x20.4 mm.

55.-

Dimension.Bottom View

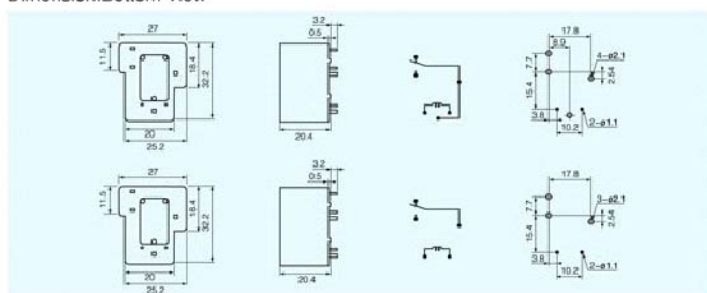

Contact Ratings

Contact Ratings	1H, 1D, 1Z
Contact Resistance	50MΩ (at 1A 6VDC)
Contact Material	Silver Alloy
Contact capacity	1H: 30A 240VAC/28VDC 1D: 15A 240VAC/28VDC 1Z: 20A 240VAC/28VDC

Coil Ratings

Rated Voltage	6~60VDC
Nominal Operating Power	2VA/0.93W

Specification

Insulation Resistance	1000MΩ
Dielectric Strength	2500VAC
Ambient Temperature	-40°C~+70°C
Operate Time	15ms/5ms
Terminal Type	PCB

RELAY

Relay Socket PY08A

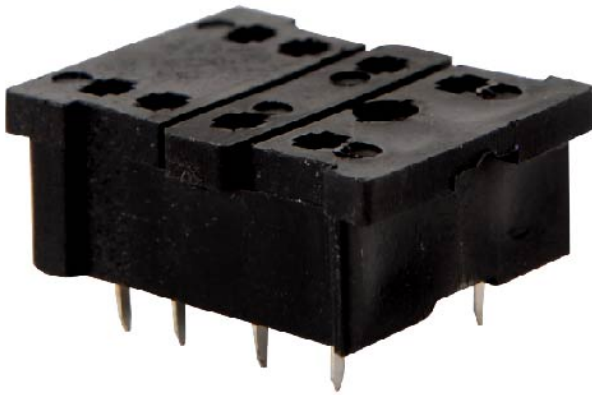

25.-

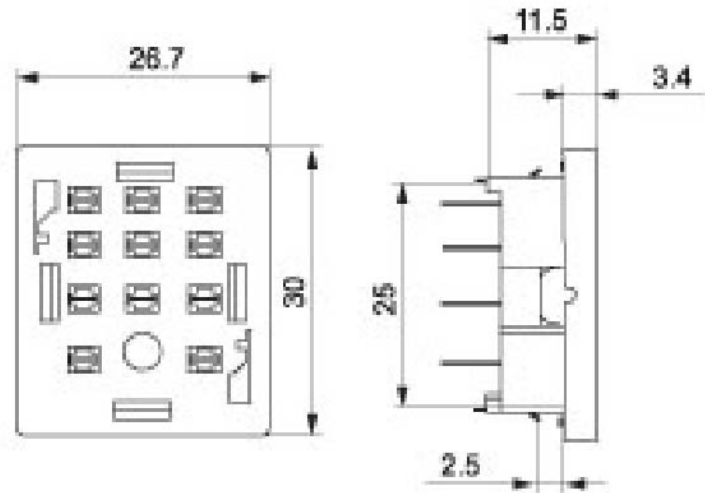

Features

- Socket mounting: PCB, with metal clamp
- Number and arrangement of pins: 8, rectangular
- Relay terminals: pin 2.4 mm.
- Size: 26.7x30 mm.

RELAY



Features

- 7A Carrying current
- SPST-NO & SPDT
- Standard PC layout
- Size: 27.6x21.5x34 mm.

85.-

PCB Relay HP 52PA 24VDC

Contact Ratings

Contact Ratings	2Z, 2C
Contact Resistance	50MΩ (at 1A 6VDC)
Contact Material	Silver Alloy
Contact capacity	28VDC/5A 250VAC/5A

Coil Ratings

Rated Voltage	6~240VAC/6~110VDC
Nominal Operating Power	0.9W/1.0W~1.3VA

Specification

Insulation Resistance	≥ 500MΩ
Dielectric Strength	≥ 1500VAC
Ambient Temperature	-45°C~+70°C
Operate Time	20ms/15ms
Terminal Type	PCB

Dimension.Bottom View

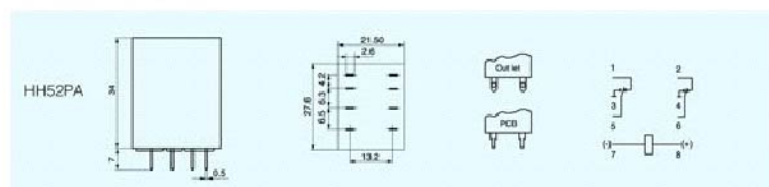



2,500.-/Pc

Outline Dimension

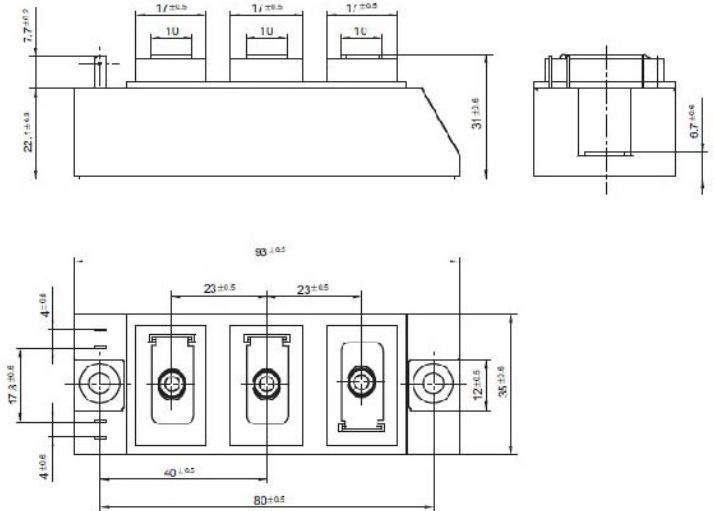

Circuit Diagram

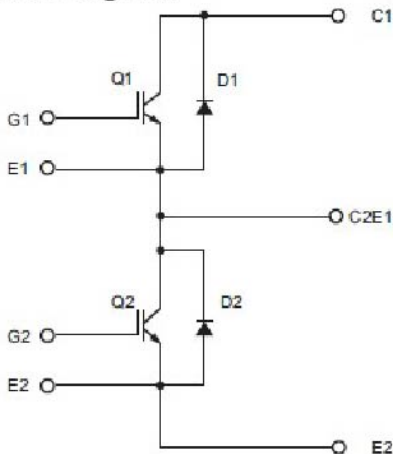

Suitable for

MIG Welding 200Y, 250Y

Feature

- Half-bridge (two IGBTs)
- SPT+ IGBT
- Including fast free-wheeling diodes
- DCB insulated base plate
- Terminals embedded plastic case
- Environmental friendly product (RoHS compliant)

Symbol	Item	Condition	Rating	Unit
V_{CES}	Collector-emitter voltage	G、E short	1200	V
V_{GES}	Gate-emitter voltage	G、E short	±20	V
I_c	Collector current	$T_c=80^{\circ}C$	95	A
I_{cP}	Peak collector current	$T_c=80^{\circ}C$	200	A
Viso	Isolation voltage		2500	VAC
T_j	Junction temperature		-40 ~ 150	$^{\circ}C$
T_{stg}	Storage temperature		-40 ~ 125	$^{\circ}C$
I_F	Diode forward current	$T_c=25^{\circ}C(80^{\circ}C)$, $T_j=150^{\circ}C$	95(70)	A
I_{FM}	Diode peak forward current	$T_c=25^{\circ}C$, $T_j=150^{\circ}C$	200	A



FRED DIODE MODULE

100A/600V

MOD. DAC2F100P6S



Fred diode module ชนิด P-type ขนาด 100A/600V
ใช้กับเครื่องตัดพลาสมา CUT-100

2,000.-/Pc

Dimensions in mm

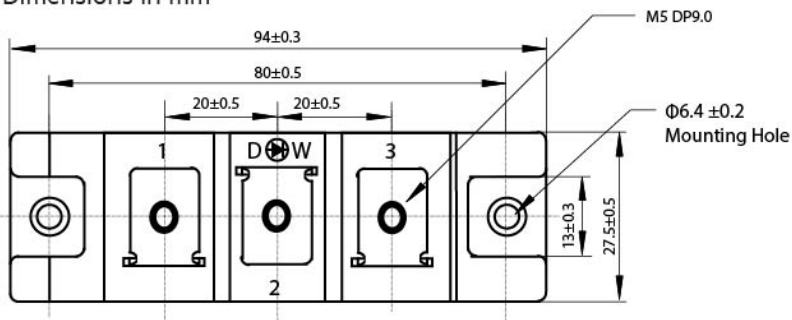

Features

- Repetitive Reverse Voltage: $V_{RRM} = 600V$
- Low Forward Voltage Drop: V_F (typ.) = 1.5V
- Average Forward Current: I_F (AV.) = 100A @ $T_c = 100^\circ C$
- Ultra-Fast Reverse Recovery Time: t_{rr} (typ.) = 120ns
- Extensive Characterization of Recory Parameters
- Reduced EMI and RFI

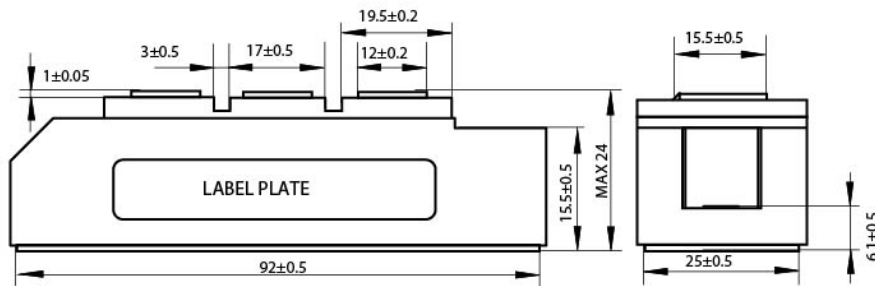

Applications

Motor Drives, Free wheel use, High Power Converters, Welders, Various Switching and Telecommunication Power Supply.

Absolute Maximum Ratings @ $T_j=25^\circ C$ (Per Leg)

Symbol	Parameter	Conditions	Ratings	Unit
V_{RRM}	Repetitive Peak Reverse Voltage		600	V
$V_{R(DC)}$	Reverse DC Voltage		480	V
$I_{F(AV)}$	Average Forward Current @ $T_c = 25^\circ C$ @ $T_c = 100^\circ C$	Resistive Load	200 100	A
I_{FSM}	Surge(non-repetitive) Forward Current	One Half Cycle at 60Hz, Peak Value	2000	A
I^2t	I^2t for Fusing	Value for One Cycle Current, $t_w = 8.3ms, T_j = 25^\circ C$ Start	$16.7 \cdot 10^3$	A ² s
T_j	Junction Temperature		-40 ~ 150	$^\circ C$
T_{stg}	Storage Temperature		-40 ~ 125	$^\circ C$
V_{isol}	Isolation Voltage	@ AC 1 minutes	2500	V
P_d	Maximum Power Dissipation		400	W
-	Mounting Torque		4.0	N.m
-	Terminal Torque		2.0	N.m
-	Weight	Typical Including Screws	140	g



ANALOG AC AMP / VOLT METER

ISO9001-2008
IEC60051, IEC61010
GB/T7676-1998
CE EN61326-1:2013,
EN55022:2010
TUV certificate



Temperature range : -10°C to +50°C
Test voltage : 2000V, 1 min
Overload atleast : 20% continuous
Accuracy : Class 1.5%

รุ่น Model	ชนิด Type	ประเภท มิเตอร์ Meter	Scale Range	การต่อสาย Primary CT(A)	Max. Amp / Voltage	ขนาด Size (mm)	ราคา Price
SF-72-30A	AC	AMPERE	0-30A (0A, 20A, 30A)	AC Direct Connection	60A	72x72	300.-
SF-72-100A	AC	AMPERE	0-100A (0A, 20A, 40A,60A,80A,100A)	AC Direct Connection	200A	72x72	300.-
SF-72-400/5A	AC	AMPERE	0-400A/5A (0A, 100A, 200A,300A,400A)	AC Direct Connection	800A	72x72	300.-
SF-96-30A	AC	AMPERE	0-30A (0A, 20A, 30A)	With Ext.CT/1Aor 5A	60A	96x96	320.-
SF-96-100A	AC	AMPERE	0-100A (0A, 20A, 40A,60A,80A,100A)	With Ext.CT/1Aor 5A	200A	96x96	320.-
SF-96-400/5A	AC	AMPERE	0-400A/5A (0A, 100A, 200A,300A,400A)	With Ext.CT/1Aor 5A	800A	96x96	320.-
SF-72-500V	AC	VOLTAGE	0-500V (0.100V,200V,300V,400V,500V)	With Ext.PT	500A	72x72	300.-
SF-96-500V	AC	VOLTAGE	0-500V (0.100V,200V,300V,400V,500V)	AC Direct Connection	500A	96x96	320.-

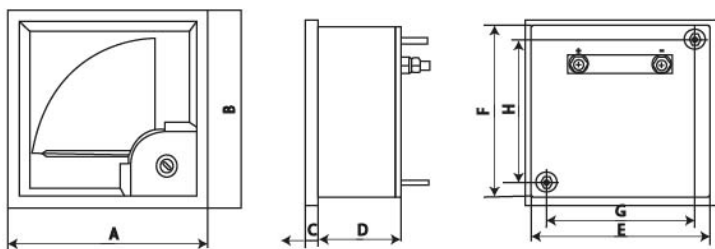

Dimension

Type	A	B	C	D	E	F	G	H
SF-96	96	96	5	44	90	90	84	84
SF-72	72	72	5	44	66	66	60	60

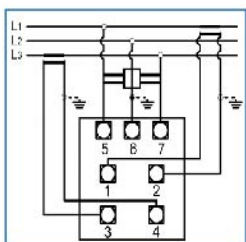

Connecting Diagram for 3 phase with 3 wire power source without voltage transformers.

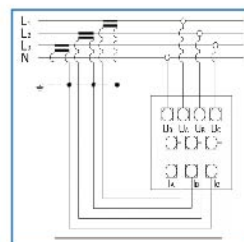

Connecting Diagram for 3 phase with 4 wire power source without voltage transformers.



ANALOG DC AMP / VOLT METER

ISO9001-2008
IEC60051, IEC61010
GB/T7676-1998
CE EN61326-1:2013,
EN55022:2010
TUV certificate



Temperature range : -10°C to +50°C
Test voltage : 2000V, 1 min
Overload atleast : 20% continuous
Accuracy : Class 1.5%

รุ่น Model	ชนิด Type	ประเภท มิเตอร์ Meter	Scale Range	การต่อสาย Primary CT(A)	ขนาด Size (mm)	ราคา Price
SFT-60 DC AMP Meter 400A	DC	AMPERE	0-400A (0A, 100A, 200A, 300A, 400A)	AC Direct Connection	60x60	520.-
SFT-60 DC AMP Meter 500A	DC	AMPERE	0-500A (0A, 100A, 200A, 300A, 400A, 500A)	AC Direct Connection	60x60	520.-
SFT-60 DC AMP Meter 600A	DC	AMPERE	0-600A (0A, 200A, 400A, 600A)	AC Direct Connection	60x60	520.-
SFT-60 DC VOLTAGE 75V	DC	VOLTAGE	0-75V (0V, 20V, 40V, 60V, 75V)	AC Direct Connection	60x60	520.-
SFT-60 DC VOLTAGE 100V	DC	VOLTAGE	0-100V (0V, 20V, 40V, 60V, 80V, 100V)	AC Direct Connection	60x60	520.-

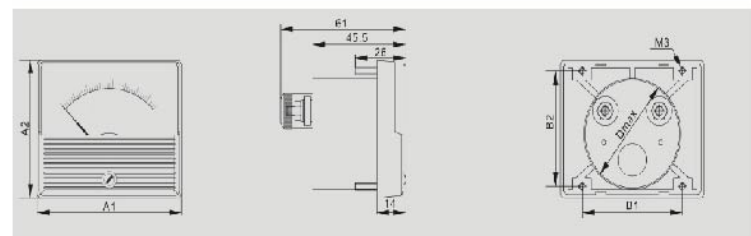

Dimension

A1 (mm)	A2 (mm)	B1 (mm)	B2 (mm)	Dmax (mm)	Hole Cutout Dimension (mm)
60	60	47.5	47.5	46.5	47.5

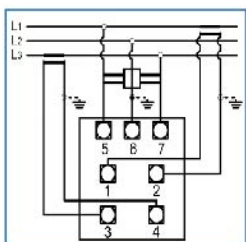

Connecting Diagram for 3 phase with 3 wire power source without voltage transformers.

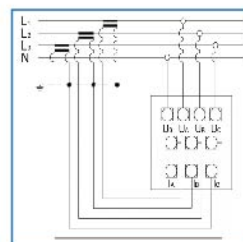

Connecting Diagram for 3 phase with 4 wire power source without voltage transformers.

Amp/Volt Meter Digital

Digital DC Volt Meter



Digital DC Amp Meter

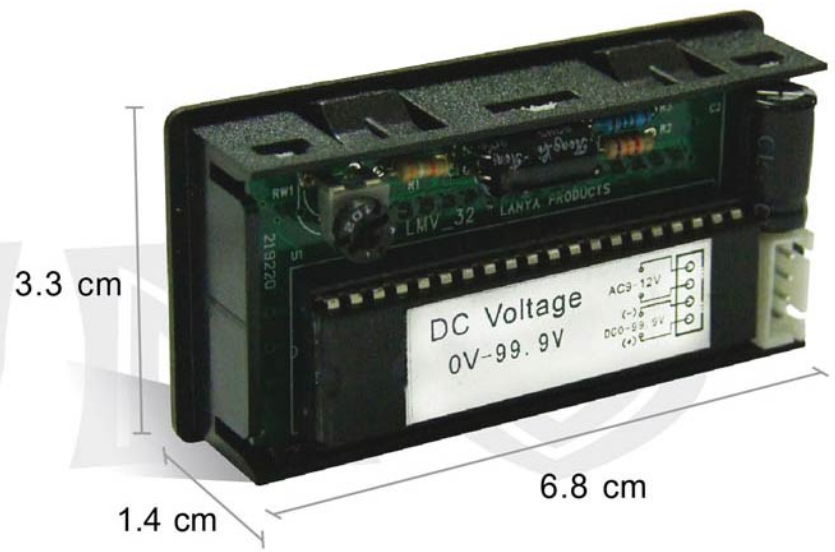

Digital DC Meter

Model	Lot	QTY.	Price
Digital DC Volt Meter	062440038052040		650.-
Digital DC Amp Meter	062440038052040		650.-

หม้อแปลงกระแส

AMC Current Transformer



Type	Rated Current (A)	Busbar Hole Dimension	Accuracy Class	Rated Burden (VA)	Rated Voltage(V)	Rated Frequency(Hz)	Weight	Packing	Price
AMC-30	30/5	30x10mm	0.5	5	660	50/60	250g/Pc	100/ctn	300.-/Pc
AMC-40	100/5	40x10mm	0.5	5	660	50/60	230g/Pc	60/ctn	400.-/Pc
AMC-60	400/5	60x20mm	0.5	10	660	50/60	230g/Pc	40/ctn	560.-/Pc

Size (Unit: mm)

Model	A	B	C	D	E	F	G
AMC-30	85	53	95	112	13	83	18
AMC-40	85	53	95	112	13	83	18
AMC-60	111	53	131	148	13	83	18

